



The Tank Guy - 06 326 8888

**VERSATILE.
RELIABLE.
STRONG.
COMPLIANT.**

STORMWATER MANAGEMENT.

*storm***VAULT**

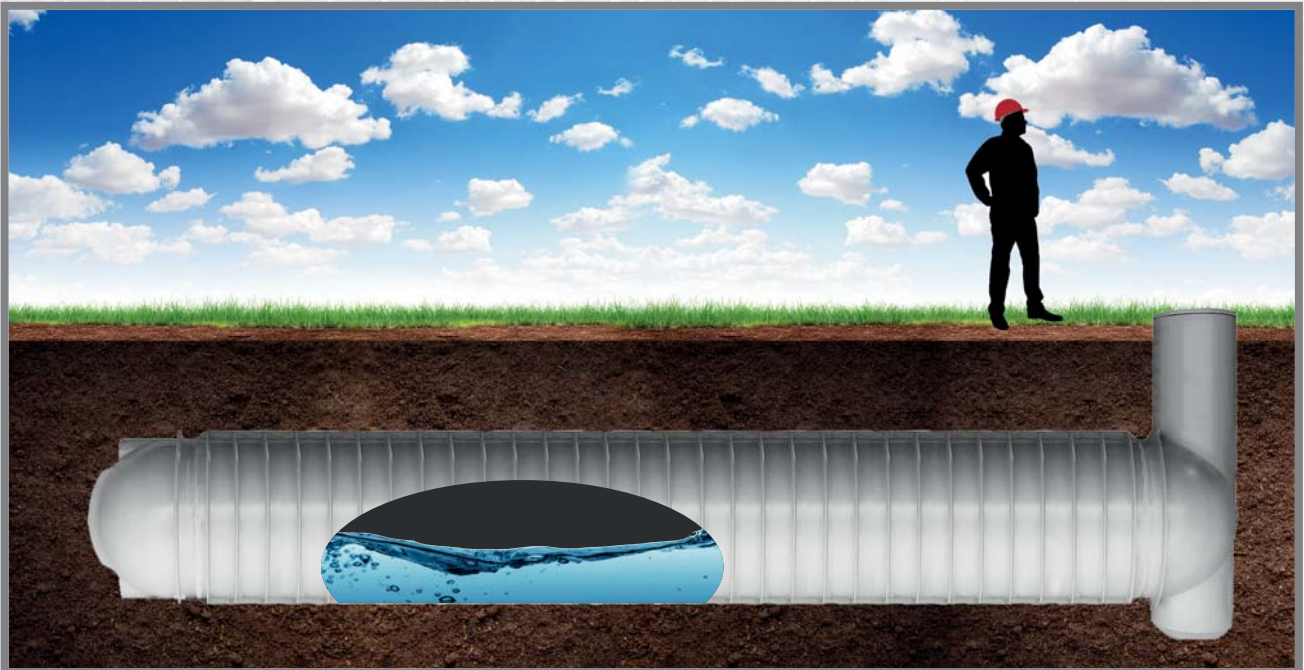

stormVAULT stormwater management tanks from Devan offer stormwater solutions with a 15-year domestic warranty and are ready to be specified in your project.



WWW.DEVAN.CO.NZ

30 YEARS OF PROVEN TANK MANUFACTURING QUALITY

Devan has been in business for over 30 years and if there is anything that time has taught us it is that our customers see no compromise when it comes to confidence and reliability.

stormVAULT stormwater tanks make specification easy

Whatever your project's soil type or water table, stormVAULT tanks are designed to meet your project's needs. Each tank is manufactured to meet whatever your volume requirements are. Standard sizes are available in any combination from 2,000L to 10,000L with other volumes available on request. The more volume you require, the longer the tank. Larger volumes are achieved by coupling multiple tanks together onsite with ease.

The tank is the strongest design on the market and has achieved compliance to AS/NZS1546 Septic Tank Standard, ARMA COP15 Underground Tank Code of Practice, and verified by CPEng Engineers here in New Zealand.

Built from environmentally friendly, long lasting material

Devan stormVAULT tanks are manufactured from the highest quality polyethylene available which is

ideally suited to our moulding technique, giving long life and trouble-free service.

The material is certified to AS/NZS4766:2006, AS/NZS4020:2005, and AS/NZS 2070.

Polyethylene cannot rot or corrode and is ultra violet stabilised for New Zealand's harsh environmental conditions. The manufacturing process produces zero waste of polyethylene and the product is 100% recyclable.

Designed for installation flexibility on New Zealand sites

The tanks have been designed for the majority of soil types and water table conditions in New Zealand. They have been built to be easily installed under your lawn, but can also be installed under concrete drive if space is a premium on your site. The tank is not reliant on surrounding soil structures for strength.

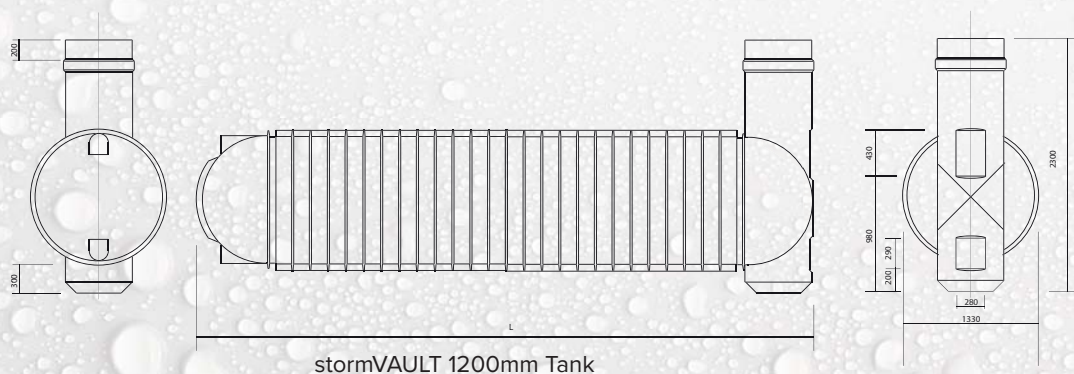

STRENGTH TESTED TO LAST LONG-TERM AND THE ASSURANCE OF A 15-YEAR DOMESTIC WARRANTY

FEA Analysis

This image of a 10,000L stormVAULT tank has been modelled and tested for performance across New Zealand's variety of soil types and water tables, not just in the short term but also modelled performance over the long term. These tanks come with the Devan 15-year domestic warranty.

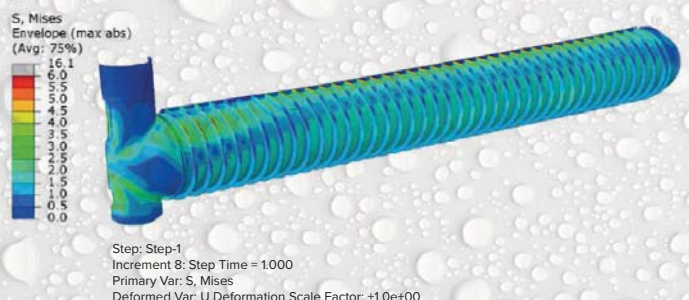

QUALITY COMPONENTS PROVIDE A TROUBLE-FREE STORMWATER SOLUTION



Solid filled rib design: The unique solid filled rib design is superior in both design and strength to withstand the ground pressures that will be applied over the lifetime of the tank.

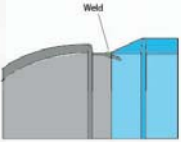

Unique interlocking jointing: The unique interlocking jointing system ensures there is no stain or reliance on the weld joints; welds are for sealing only – not holding together.



Heavy, thick, strong: We understand the demands put on products that go underground. For this reason, the stormVAULT is the thickest and heaviest product on the market and exceeds design standards.



Anti-floatation anchors: Made from high-quality products that include polypropylene restrains and 316 grade stainless steel fitting, these anchors will stand the test of time.



Standard garden lid: Made from high-quality polyethylene with child resistant 316 grade stainless steel, ensuring the lid remains secure. 510mm internal opening offers easy access for inspection and maintenance.

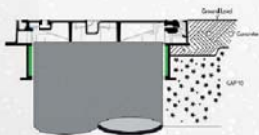

Ductile iron lids: stormVAULT tanks are strong enough to be buried under domestic and commercial driveways and, as an option, can come with a ductile iron adaptor kit to adapt to a standard 600mm internal clearance ductile iron lid.

1200 SERIES PRODUCT CODES

CODE	TANK VOLUME	LENGTH (M)	WEIGHT (KG)
SVR12-02	2,000L	2.3	170
SVR12-03	3,000L	3.2	225
SVR12-04	4,000L	4.1	280
SVR12-05	5,000L	5.0	340
SVR12-06	6,000L	5.9	395
SVR12-07	7,000L	6.7	450
SVR12-08	8,000L	7.7	510
SVR12-09	9,000L	8.6	570
SVR12-10	10,000L	9.5	625

ACCESSORY PRODUCT CODES

CODE	LID TYPE
SVALP	stormVAULT plastic lid
SVALDC	Cast iron lid class D – commercial trafficable
SVALAR	stormVAULT adaptor ring and temporary lid
SVGA-12	stormVAULT ground anchor set – 1200mm
SVKOV100	stormVAULT 100mm over-flow kitset

0800 338 268

NI. 07 578 8726 | SI. 03 344 1065

*storm***VAULT**

DEVAN



the
tank
GUY

BEST QUALITY | BEST PRICE

Available from : The Tank Guy
30 Turners Rd
Fielding
Ph 06 326 8888
www.thetankguy.co.nz

WWW.DEVAN.CO.NZ